



Darby Drive is a small retail development in the market town of Waltham Abbey. The property fronts Darby Drive offering good frontage, with high pedestrian and vehicle passing trade. The shop is offered in good decorative order, comprising circa 250 square foot.

New lease by negotiation
 Rental amount £9,500 pa

Lease Terms

Offered for long or short term lease

Usage

A1 Retail

Annual Service Charge

The annual service charges for this unit are £715.30 for the current year of 9th June 25 to 8th June 26. This includes apportioned costs for buildings insurance, cleaning of communal areas, communal electricity, general maintenance and refuse collection at the development.

GROUND FLOOR
 245 sq.ft. (22.8 sq.m.) approx.

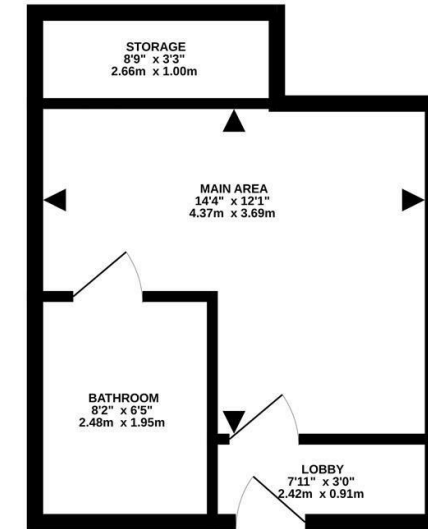

TOTAL FLOOR AREA: 245 sq ft (22.8 sq.m.) approx.
 While every attempt has been made to ensure the accuracy of the floorplan contained here, measurements of doors, windows, rooms and any other items are approximate and no responsibility is taken for any error, omission or misstatement. This plan is for illustrative purposes only and should be used as such by any prospective purchaser. The services, systems and appliances shown have not been tested and no guarantee, as to their operability or efficiency can be given.
 Made with Metage 12/2017

Energy Efficiency Rating		
	Current	Potential
Very energy efficient - lower running costs		
(92 plus) A		
(81-91) B		
(69-80) C		
(55-68) D		
(39-54) E		
(21-38) F		
(1-20) G		
Not energy efficient - higher running costs		
England & Wales		EU Directive 2002/91/EC 